



# ALTAIR<sup>®</sup> io360

## Gas Detector



THE FUTURE OF AREA MONITORING.

WE KNOW WHAT'S AT STAKE.

## The Simple Usability of a Smart Home Product. The Rugged, Reliable Performance You Expect from MSA.

You shouldn't need IT skills and special equipment to set up your area monitoring network—it should just work. ALTAIR io360 Gas Detectors are preconfigured and ready-to-go out of the box, requiring less time for training and setup.

Guided setup, installation tips, and real-time feedback replace complex instructions, scrolling through screens, and overwhelming menu selections. All you need are a few quick swipes on the Safety io Grid mobile app to know you got it right the first time.

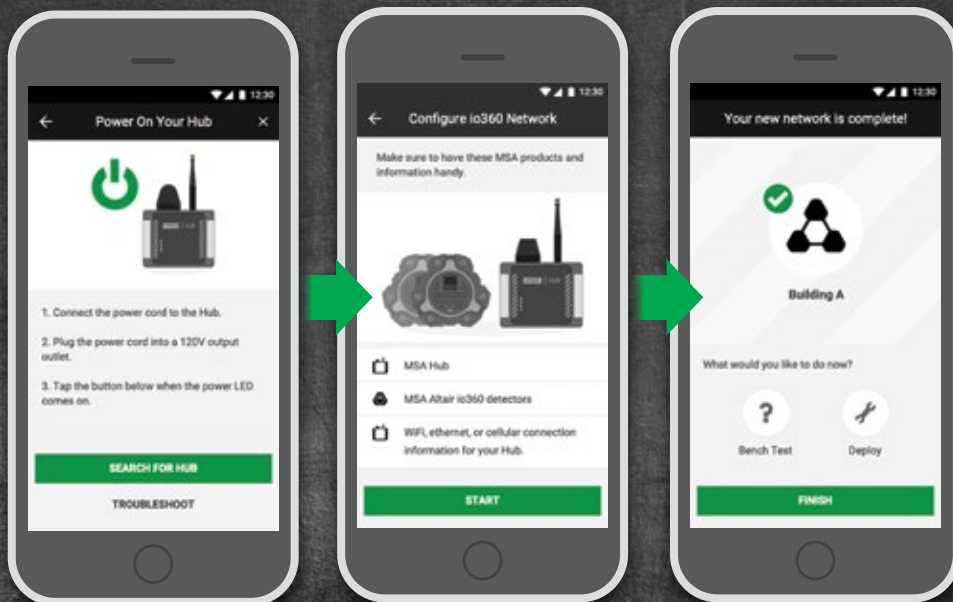



## Flexible Monitoring and Effortless Connectivity Make Your Workers and Job Sites Safer

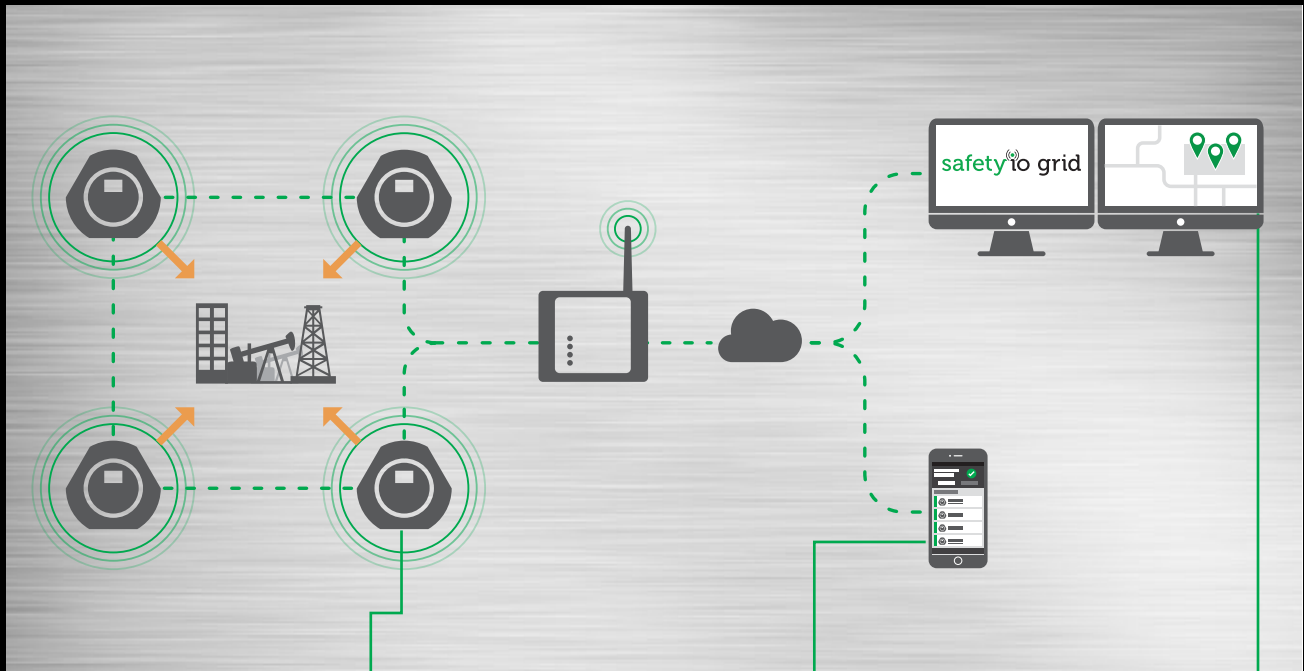

Gas detection and local alarms for high-risk areas.  
Just turn on your ALTAIR io360 Gas Detectors and deploy where needed.



The MSA HUB allows up to 16 ALTAIR io360 Gas Detectors to form a network you manage locally via the Safety io Grid mobile app.



Connecting your gas detection network to Safety io Grid gives you the power to remotely manage and monitor your fleet of detectors, capture data, and take action to create safer sites.

## Monitor Along a Fenceline, Confined Space or Any High-Risk Area Where a Gas Hazard Might Occur.



Downstream



Midstream



Upstream



Chemical  
Plants



Emergency  
Response



Underground  
& Vessels



Construction



### GENERAL AREA MONITORING

Place throughout your site during a high-risk operation or whenever you need additional detection.



### PERIMETER MONITORING

Cover an entire fence line or create smaller detection perimeters around a targeted work area.

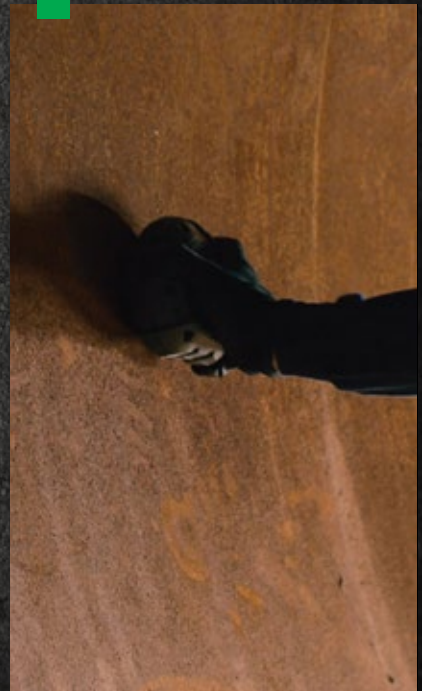

### CONFINED SPACE MONITORING

Place detectors in a confined space for continuous monitoring, even in a zone 0 location.



## The ALTAIR io360 Gas Detector Offers a Combination of Runtime and Sensor Performance, Unmatched in the Industry. No Compromises.

Most area monitors have runtimes measured in hours or days.

The ALTAIR io360 Gas Detector gives you *months*—  
in a hand held, compact design. You spend less time maintaining, more time monitoring.

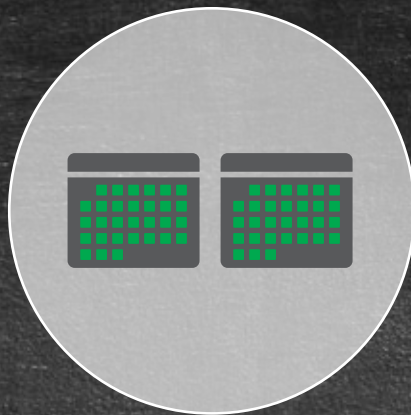

**50-60 DAYS**  
**4 GAS**

Catalytic Bead Combustible, O<sub>2</sub>, & CO/H<sub>2</sub>S



**80-85 DAYS**  
**1-3 GAS**

O<sub>2</sub> & CO/H<sub>2</sub>S

When batteries near end-of-life, respond proactively and minimize unplanned downtime...  
the ALTAIR io360 Gas Detector notifies you locally and remotely.

### Better Sensors Mean Better Performance.

#### WITH MSA XCELL® SENSOR TECHNOLOGY, YOU GET:

The fastest response time.

Better stability and accuracy.

4 years of expected life for combustible and toxic sensors.

End-of-life warning to minimize downtime.



ALTAIR io360 Gas Detector use XCell® Combustible and Toxic sensors

# The Rugged, Compact Design You Expect From MSA. With an IP68 Rating.

You work in tough environments. Your gas detectors need to work in them too.

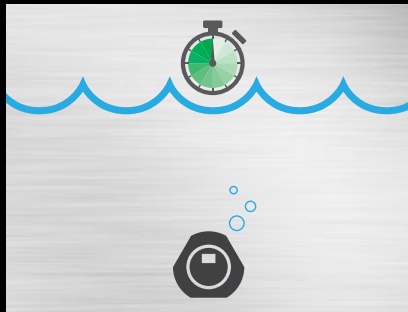

## SUBMERGE IT\*

2 m for  
up to 60 minutes.

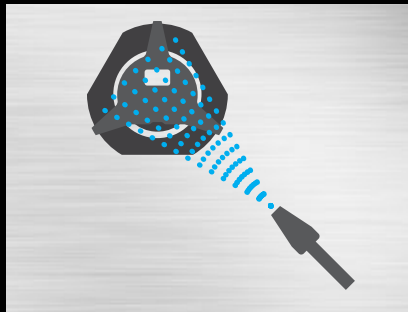

## SPRAY IT\*

Resistant to sprays.

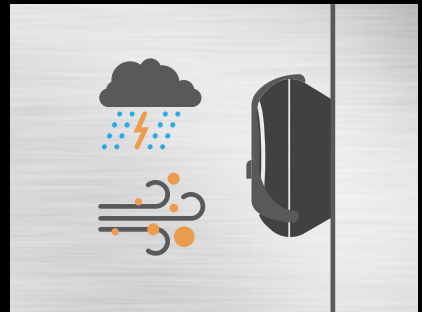

## WEATHER IT\*

Withstands heavy rain,  
wind, and dust.



## STICK IT

220 Newton  
force magnet.

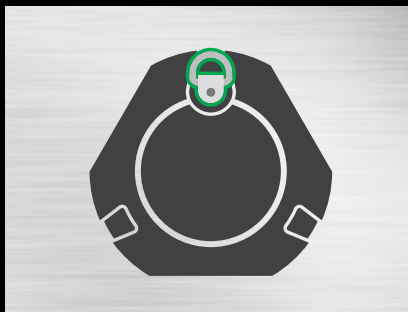

## HANG IT

Integrated D-ring.

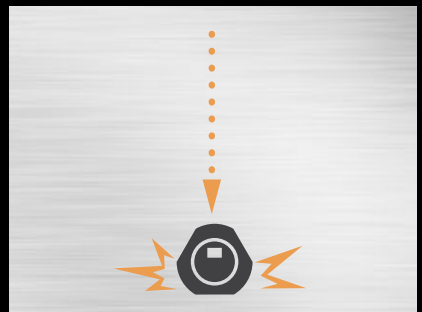

## DROP IT

Drop tested  
at 3 m.



## COMPACT

0.73 kg  
No external antennas or battery packs.



## PORTABLE

Carry multiple detectors at a time. Make fewer trips  
when deploying. Save time and hassle.

\*consistent/pass with testing requirements of IP68.

## Specifications

### ALTAIR io360 Gas Detector Specification

<b>WARRANTY</b>	4 years <b>Oxygen Sensor:</b> 2 years <b>Low-energy Combustible:</b> 1 year															
<b>DURABILITY</b>	<b>Drop Test:</b> 3 m <b>Ingress Protection:</b> IP68															
<b>TEMPERATURE</b>	<b>Normal Operating:</b> -20° to 55° C <b>Extending Operating:</b> -40° to 55° C <b>Storage:</b> 0 to 35 °C															
<b>HUMIDITY</b>	<b>Intermittent:</b> 5%–95% <b>Non-condensing:</b> 15%–90%															
<b>POWER</b>	<b>Batteries:</b> 3 replaceable lithium thionyl chloride batteries <b>Runtime:</b> nominally 50-60 days 4-gas, 80-85 days without combustible sensor															
<b>PHYSICAL</b>	<b>Weight:</b> 0.7 kg <b>Dimensions:</b> 132 x 142 x 69 mm															
<b>ALARMS</b>	<b>Audible:</b> 90 dB @ 0.3 m <b>Visual:</b> RGB LED															
<b>DATA LOGGING</b>	Periodic, Event, Instrument, Calibration logs stored on detector (at least 2 months) and sent to Safety io Grid.															
<b>RANGE</b>	Up to 300 m line of site HUB to detector 2 mesh hops to extend range.															
<b>RADIO</b>	868 MHz (region dependent), Bluetooth, RFID															
<b>SENSORS</b>	<table><tr><th>Gas</th><th>Range</th><th>Resolution</th></tr><tr><td>LEL</td><td>0-100%</td><td>1%</td></tr><tr><td>O<sub>2</sub></td><td>0-30%</td><td>0.1%</td></tr><tr><td>CO</td><td>0-1999 ppm</td><td>1 ppm</td></tr><tr><td>H<sub>2</sub>S</td><td>0-200 ppm</td><td>1 ppm</td></tr></table>	Gas	Range	Resolution	LEL	0-100%	1%	O <sub>2</sub>	0-30%	0.1%	CO	0-1999 ppm	1 ppm	H <sub>2</sub> S	0-200 ppm	1 ppm
Gas	Range	Resolution														
LEL	0-100%	1%														
O <sub>2</sub>	0-30%	0.1%														
CO	0-1999 ppm	1 ppm														
H <sub>2</sub> S	0-200 ppm	1 ppm														

### MSA HUB Specifications

<b>WARRANTY</b>	4 years
<b>DURABILITY</b>	Ingress protection IP67
<b>TEMPERATURE RANGE</b>	-20° to +60° C for hazardous locations
<b>HUMIDITY</b>	10 to 90% relative humidity, non-condensing
<b>POWER</b>	<b>Nominal:</b> 24 V DC line power <b>Range:</b> 6 V to 32 V
<b>PHYSICAL</b>	<b>Weight:</b> 1.4 kg <b>Dimensions:</b> 190mm x 195mm x 99mm
<b>RADIO</b>	868 MHz, Bluetooth, 2.4 GHz Wi-Fi (a,b,g,n)
<b>ETHERNET</b>	10/100 mbit

## Certifications

### ALTAIR io360 Gas Detector Certifications\*\*

<b>UL (U.S.)</b>	
<b>DIVISION</b>	Class I, Division 1, Groups A, B, C, and D
<b>ATEX</b>	
<b>ZONE</b>	II 1G Ex da ia IIC T4 Ga
<b>IEC</b>	
<b>ZONE</b>	Ex da ia IIC T4
<b>General</b>	
<b>TEMPERATURE RATING</b>	T4, -40°C ≤ Ta ≤ +60°C

### MSA HUB Certifications\*\*\*

<b>QPS/CSA</b>	
<b>DIVISION</b>	Class I, Division 2, Groups A, B, C, and D
<b>ZONE</b>	Ex ec IIC T4 Gc (Zone 2)
<b>ATEX</b>	
<b>ZONE</b>	II 3G ec [ic] IIC T4 Gc
<b>IEC</b>	
<b>ZONE</b>	Ex ec [ic] IIC T4
<b>General</b>	
<b>TEMPERATURE RATING</b>	-20°C ≤ Ta ≤ +60°C

\*\* CSA & Inmetro Pending

\*\*\* Inmetro Pending

Additional certification information available at [msasafety.com](https://msasafety.com).

## ENHANCE YOUR ALTAIR io360 GAS DETECTOR EXPERIENCE

**safety<sup>io</sup> grid**



### FLEET MANAGER

Assess, address, & share your MSA fleet status—all from your browser.



### LIVE MONITOR

Know what's going on—and take action—when seconds count.

For more information, please visit [safetyio.com](https://safetyio.com).

**This is the Future  
of Area Monitoring.**

## **This is the ALTAIR io360 Gas Detector.**

Both the detectors and the networks can be quickly and easily reconfigured for your changing needs.

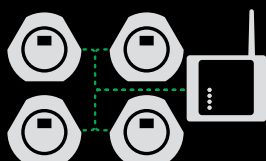

### **PRE-CONFIGURED KITS** **4, 8, OR 16 ALTAIR io360 GAS DETECTORS** **+ 1 MSA HUB**

For users who want one configuration of gas detector. HUB and detectors are paired as a network, for ready, out-of-the-box experience. Detectors can be added, dropped, and/or reconfigured using the Safety io Grid mobile app.



### **CUSTOM OPTIONS** **ANY NUMBER OF ALTAIR io360 GAS DETECTORS** **& MSA HUBS**

For users whose needs may change from job to job or who plan to have larger fleets. Order multiple detectors and HUBs, and easily construct networks with the Safety io Grid mobile app.

### **ALTAIR io360 Gas Detector Basic Configurations\***

ATEX Configurations	Quantity	Color	
		Black	Green
LEL, O <sub>2</sub> , CO/H <sub>2</sub> S	Preconfigured Kits with MSA HUB	4 pack 10207453	10207457
		8 pack 10207454	10207436
		16 pack 10207465	10207441
	Single Detector	1 pack 10207468	10207440
H <sub>2</sub> S	Preconfigured Kits with MSA HUB	4 pack 10207422	10207404
		8 pack 10207433	10207175
		16 pack 10207418	10207180
	Single Detector	1 pack 10207417	10207425

### **Accessories\***

<b>10200410</b>	MSA HUB, ALTAIR io360, 868 MHz
<b>10195741-SP</b>	MSA HUB ethernet cable
<b>10205504</b>	Sunshield, io360

### **Calibration\***

<b>10207603</b>	58 L, Methane 2.5%, O <sub>2</sub> -15%, CO-60 ppm, H <sub>2</sub> S-20 ppm
<b>10155918</b>	58 L, H <sub>2</sub> S-20 ppm
<b>467895</b>	Fixed flow regulator

### **Replaceables & Spares\***

<b>10201430</b>	Replacement kit, battery, 3 pack, io360
<b>10201438</b>	Sensorshield, replacement, io360
<b>10201439</b>	Cap, calibration, replacement, io360
<b>10203709</b>	Replacement kit, combustible sensor, io360
<b>10203721</b>	Replacement kit, comb-evo sensor, io360
<b>10203724</b>	Replacement kit, O <sub>2</sub> sensor, io360
<b>10203710</b>	Replacement kit, CO/H <sub>2</sub> S sensor, io360
<b>10201433</b>	Replacement kit, horn, io360
<b>10201434</b>	Replacement housing front, black, io360
<b>10201435</b>	Replacement housing back, black, io360
<b>10205505</b>	Replacement housing front, green, io360
<b>10205506</b>	Replacement housing back, green, io360
<b>10201437</b>	Replacement kit, screws, io360
<b>10205507</b>	ALTAIR io360, sensor plug kit
<b>10203573-SP</b>	MSA HUB AC cord, EU (type F)
<b>10208253-SP</b>	MSA HUB AC cord, UK (type G)
<b>10208432-SP</b>	MSA HUB AC cord, SA (type D)
<b>10208433-SP</b>	MSA HUB AC cord, DK (type K)

\*Need something different? Visit [www.msasafety.com](http://www.msasafety.com) or Contact MSA for more options.

Note: This Bulletin contains only a general description of the products shown. While product uses and performance capabilities are generally described, the products shall not, under any circumstances, be used by untrained or unqualified individuals. The products shall not be used until the product instructions/user manual, which contains detailed information concerning the proper use and care of the products, including any warnings or cautions, have been thoroughly read and understood. Specifications are subject to change without prior notice.

MSA operates in over 40 countries worldwide. To find an MSA office near you, please visit [MSAsafety.com/offices](http://MSAsafety.com/offices).